

CIVIL PROJECT

Jeanie Hess

METC 107

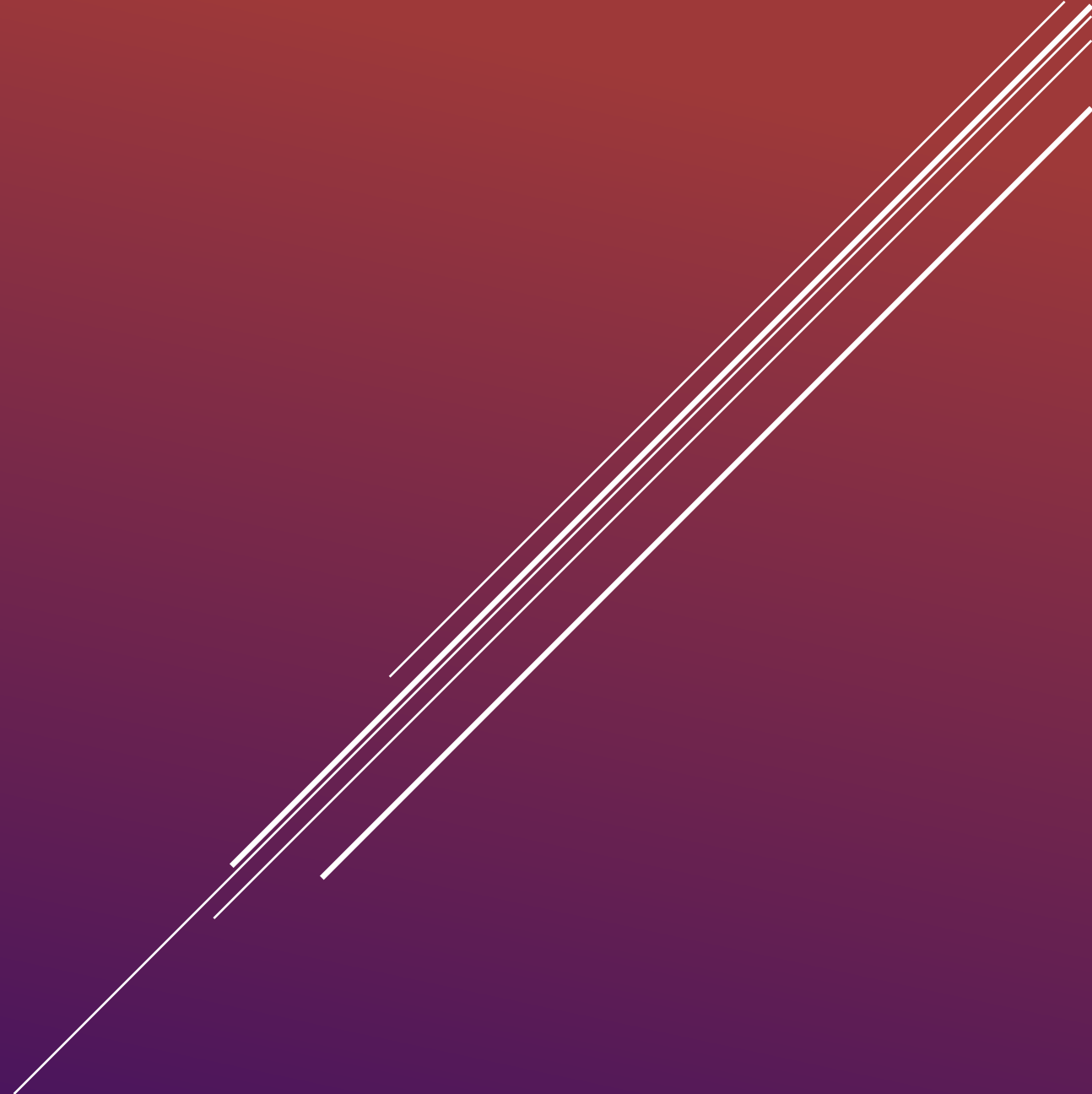

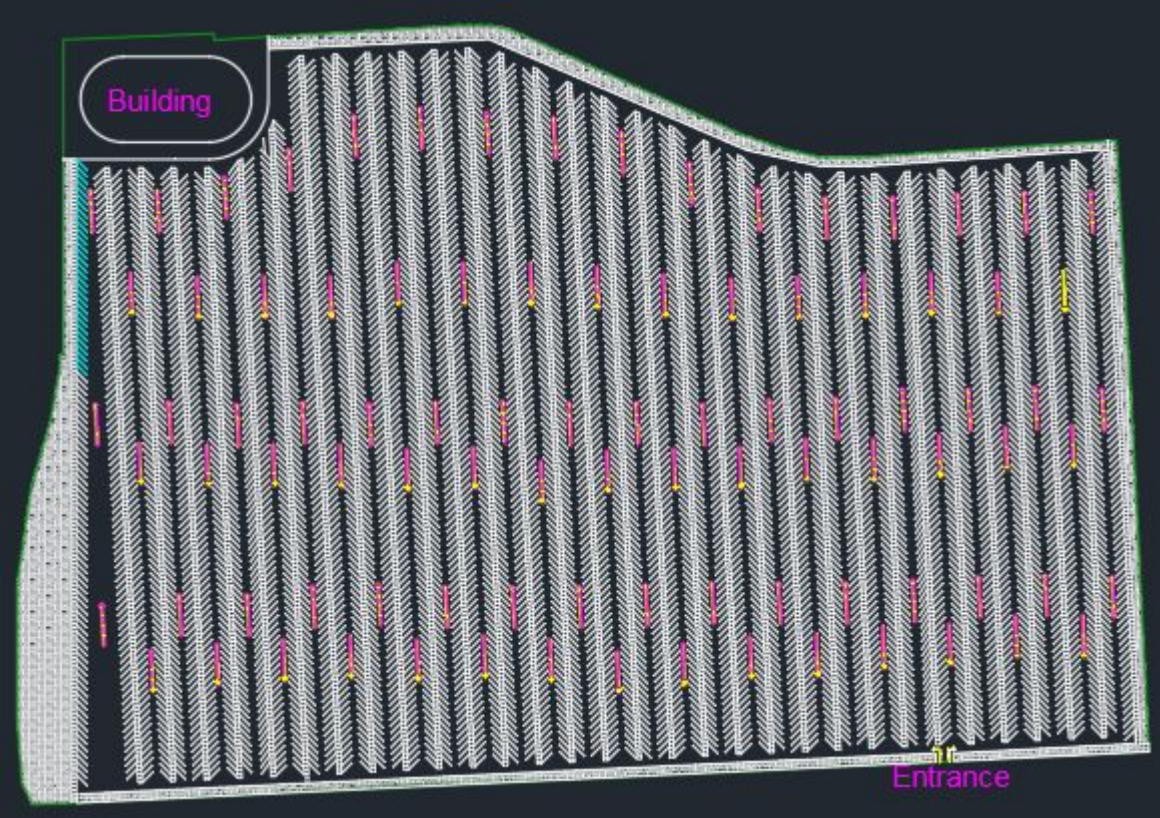

MY SITE LAYOUT

I decided to use vertical design

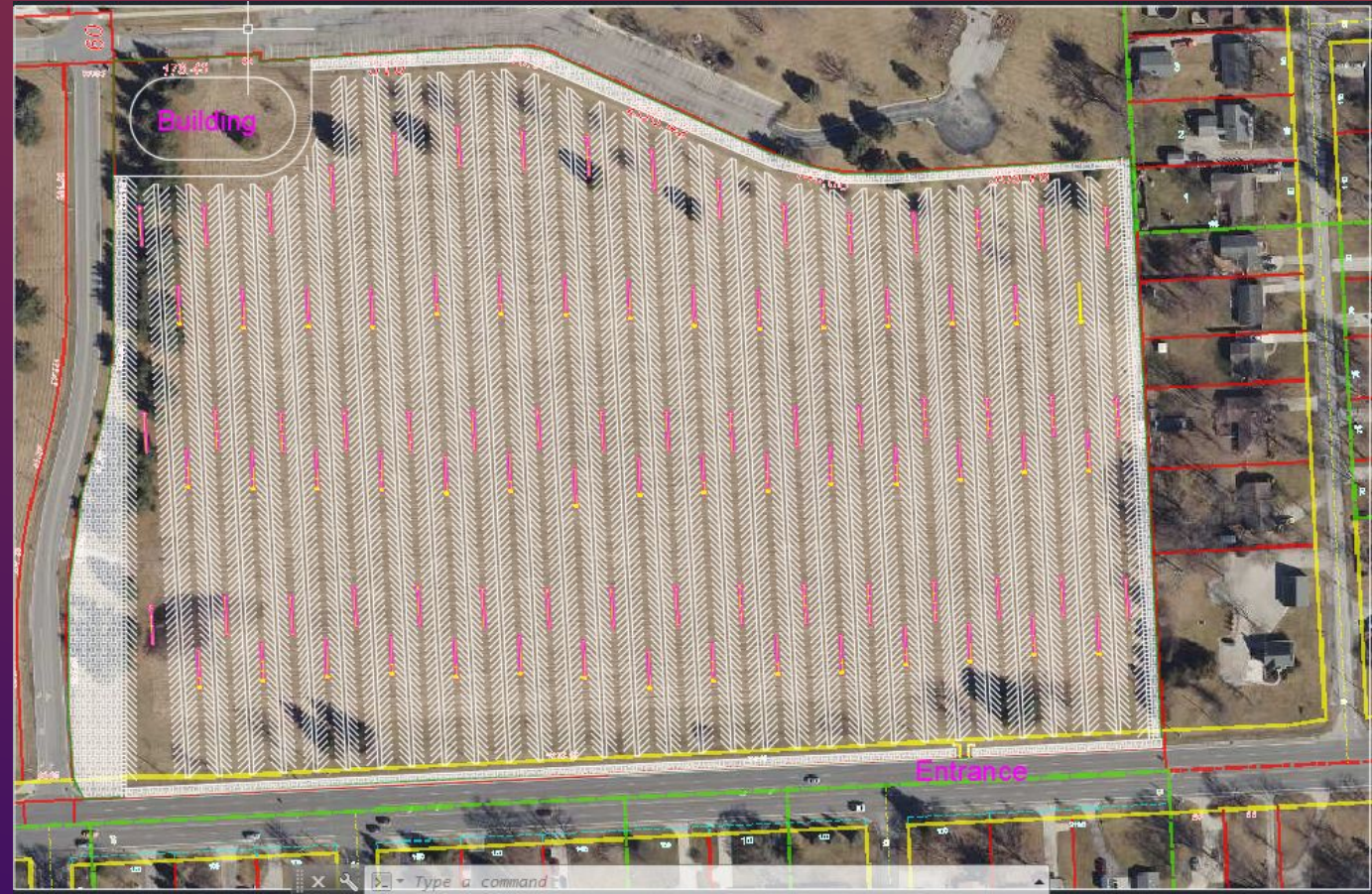

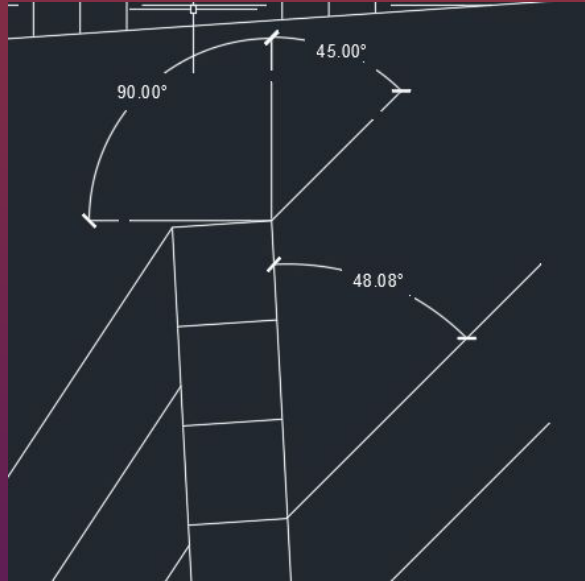
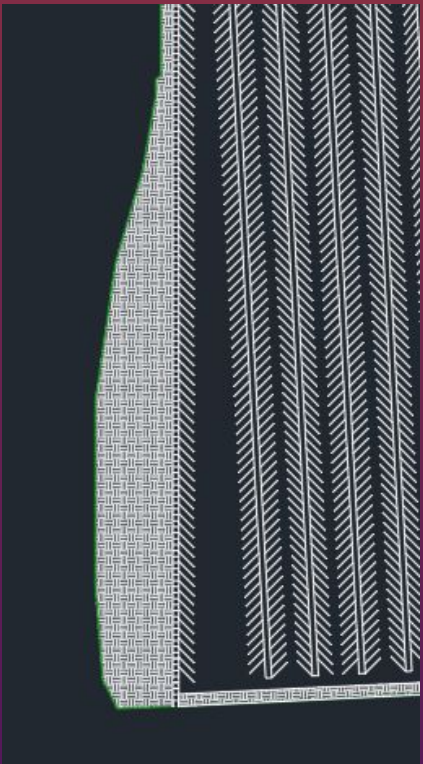

- ▶ Using the landscape shape, the rows ended up being 93 degrees
 - ▶ Not equal on both sides
 - ▶ Leaving this space
- ▶ No breaks in isles
- ▶ Not 45 degree spots

DISADVANTAGES

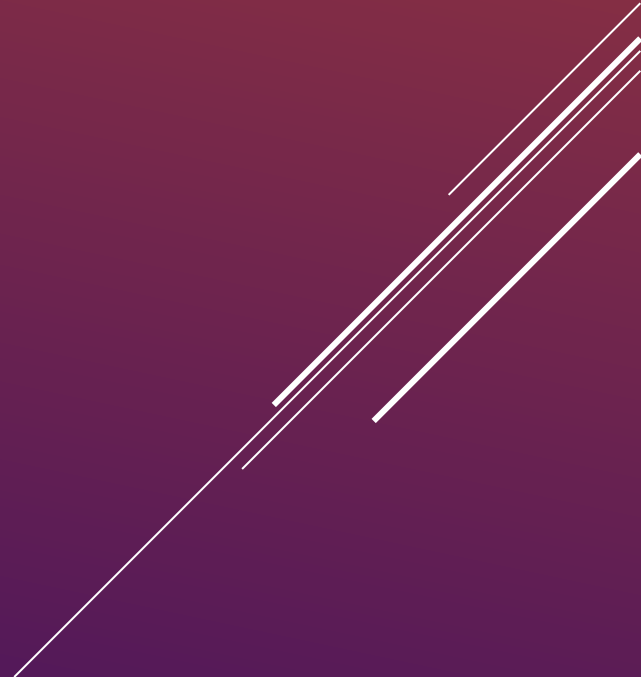

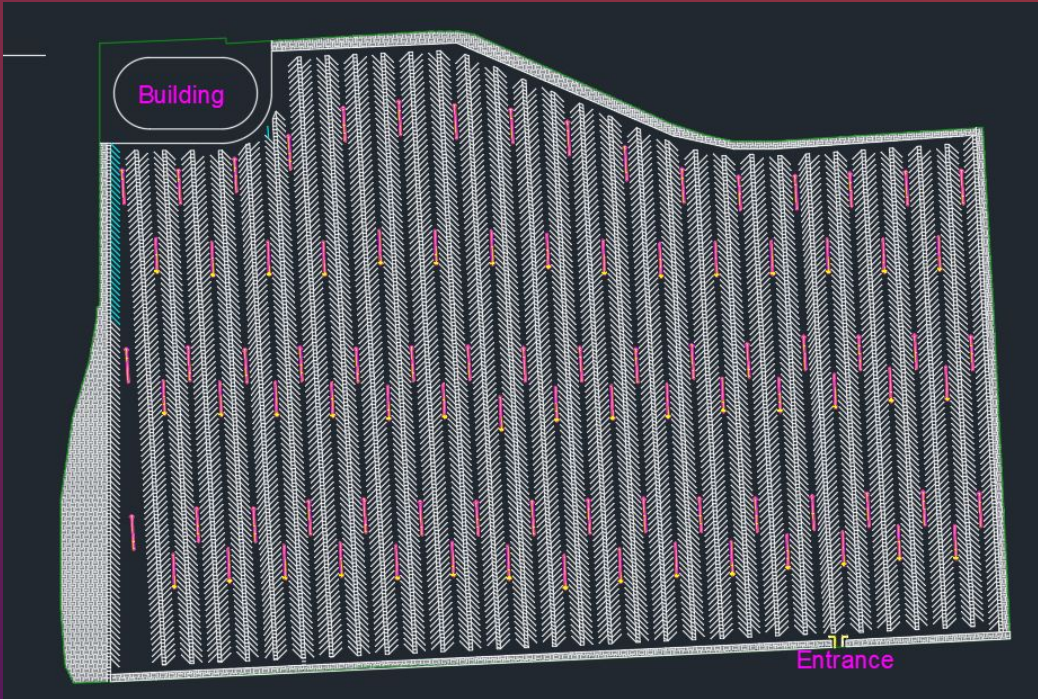

- ▶ About 5675 parking spots

SPTS

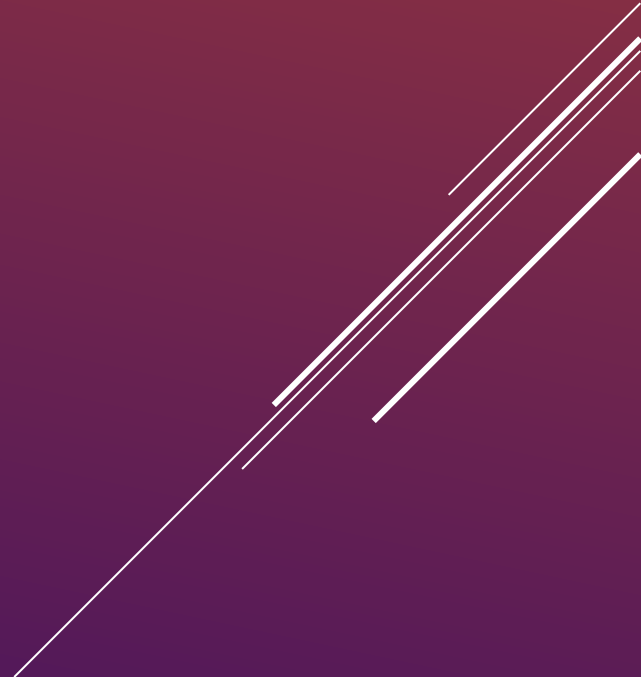

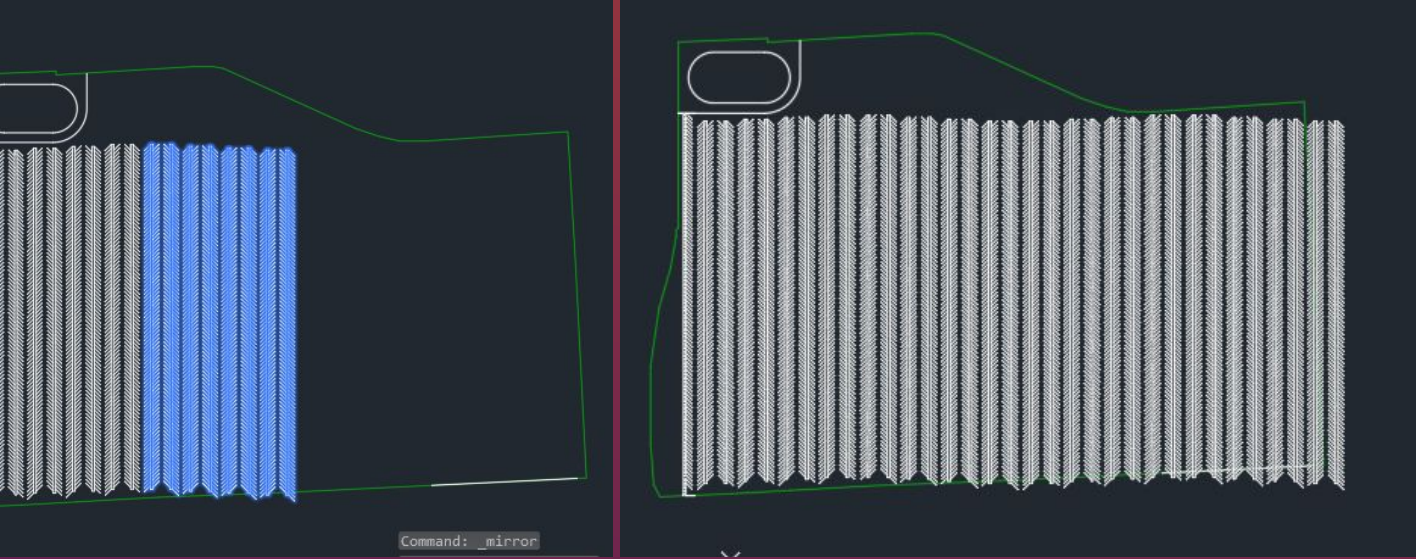

HOW IT WAS MADE

- Line
- Array
- Extension
- Trim
- Measure
- Offset

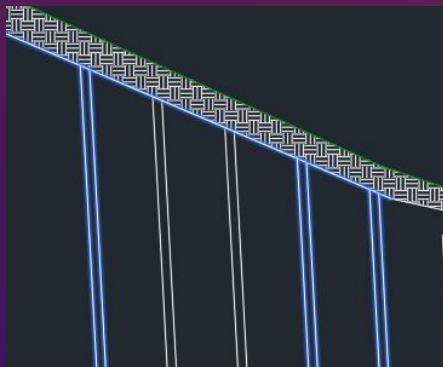
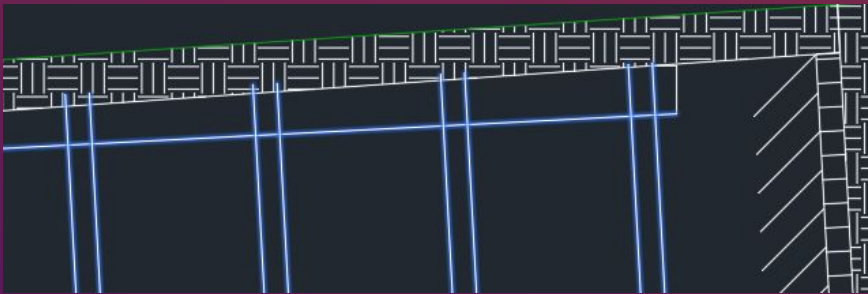

Type	Items	Rows	Levels
Path	Items: 83	Rows: 1	Levels: 1
	Between: 8'-0"	Between: 19'-1 1/8"	Between: 1"
	Total: 656'-0"	Total: 19'-1 1/8"	Total: 1"

ACCESS POINT

This access location because it would be easy to use the middle turn lane provided.

This also avoids traffic from the other entrance.



THANK YOU

